

Thank you for attending the 2020 Maryland Student Affairs Conference.

We hope you enjoyed your day with us! Please complete the final conference evaluation at go.umd.edu/msac2020

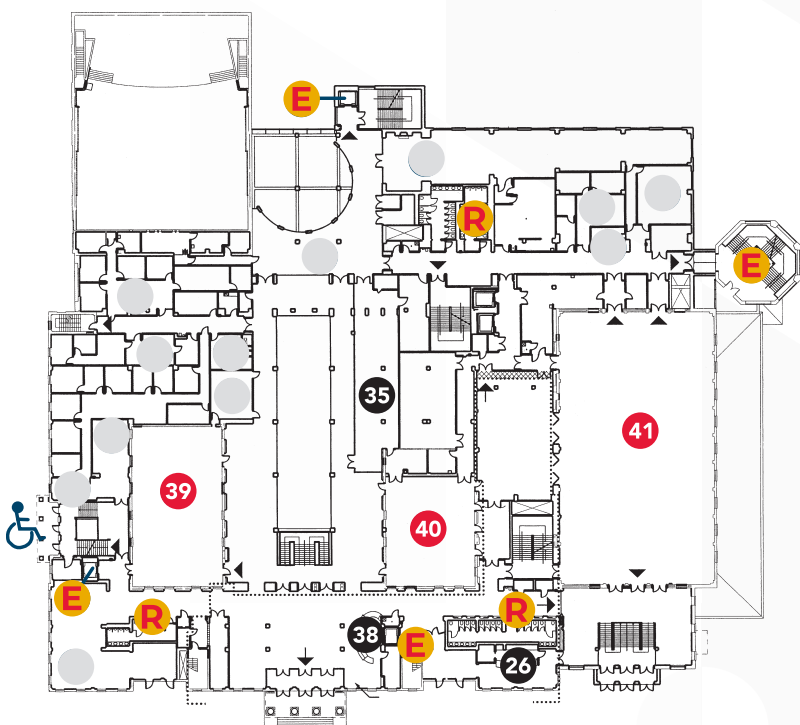

FIRST FLOOR

26 The Coffee Bar
35 Union Gallery
38 Information Desk
39 Atrium
40 Prince George's
41 Grand Ballroom & Lounge

R Restrooms

E Elevator

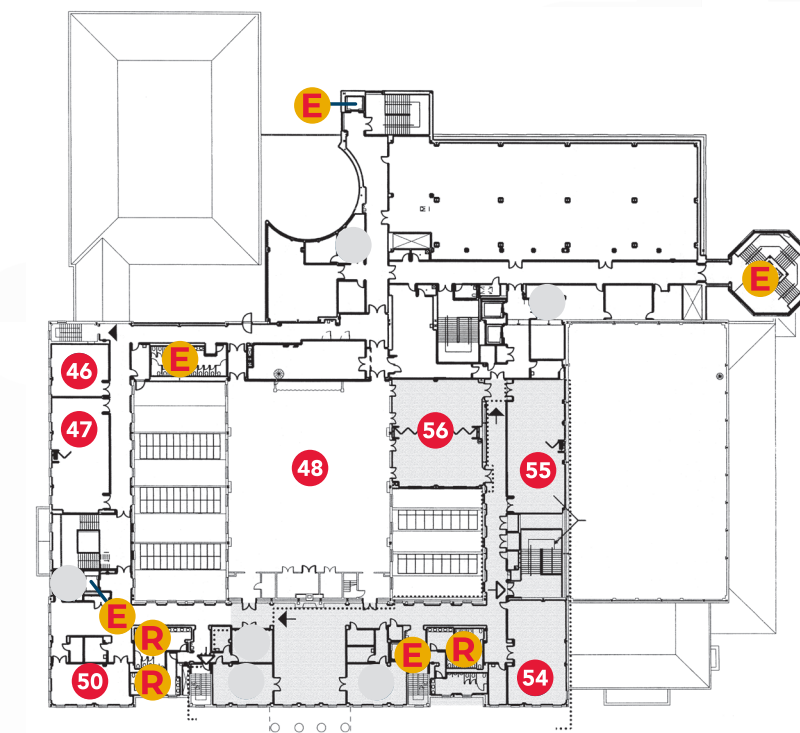

SECOND FLOOR

46 Thurgood Marshall
47 Margaret Brent
48 Colony Ballroom
50 Pyon Su
54 Juan Ramon Jiménez
55 Benjamin Banneker
56 Charles Carroll

R Restrooms

E Elevator

*Hoff Theater is located on the ground floor of the Stamp Student Union

THE MARYLAND STUDENT AFFAIRS CONFERENCE 2020

8:00AM-9:00AM	Registration: Stamp Student Union Lobby Morning Refreshments: Atrium
9:00AM-10:00AM	Welcome & Keynote Speaker: Hoff Theater
10:15AM-11:15AM	Interest Sessions Block I
11:20AM-12:20PM	Interest Sessions Block II
12:30PM-1:45PM	Lunch: Grand Ballroom
2:00PM-3:00PM	Interest Sessions Block III
3:05PM-4:05PM	Interest Sessions Block IV
4:00PM-4:45PM	Closing Reception: Atrium

*Reflection room in Thurgood Marshall available from 8:00AM-5:00PM.
This room is open to all conference participants to reflect on sessions or catch up on quick phone calls or emails.

Session I

10:15AM-11:15AM Juan Ramon Jimenez	Hear Our Voices. Understand Our Perspective: A Chance to Learn from Students with Disabilities Nancy Forsythe, Adith Thummalapalli, Jake Dahreddine, Juhi Narula University of Maryland, College Park
10:15AM-11:15AM Charles Carroll B	The Power of Collaboration to Advance Innovation: A Case Study in Dining Services Allison Tjaden, Lee-Ellen Myles, Madelyn Miller University of Maryland, College Park
10:15AM-11:15AM Benjamin Banneker A	Undergraduate Multicultural Advocates in Action in the Residence Halls Benjamin Beltran, Mary Breaker University of Maryland, College Park
10:15AM-11:15AM Margaret Brent B	STAMP GROW: Transforming Student Employment into a High Impact Practice Marinel Martinez-Benyarko, Mieshon Williford, Erica Simpkins, Brandon Smith, Nathan Grine University of Maryland, College Park
10:15AM-11:15AM Benjamin Banneker B	You are Welcome at My Institution: Establishing Best Practices to Support International Students Affected by the Travel Ban Sama Sabihi, Greg Weaver University of Maryland, College Park
10:15AM-12:20PM Margaret Brent A	Assessment Activator (120 minute session) Sophie Tullier, Kelly Schrader, Sarah Wilson, Christine Licata-Hoang University of Maryland, College Park
10:15AM-11:15AM Charles Carroll A	Informing, Educating, Advising, Supporting and Listening: The Many Roles Student Affairs Practitioners Play When Engaging Parents and Guardians Mary Hummel, Andrea Crabb, Andrea Goodwin, Brian Watkins University of Maryland, College Park
10:15AM-11:15AM Pyon Su	Power Trip: Prioritizing the Roles that We Play in the Process of Change Tynesha McCullers, Samuel Doty, Jonathan Garcia, Deeksha Walia University of Maryland, College Park

Session II			
11:20AM–12:20PM Juan Ramon Jimenez CEU	Turning Research into Action - Combating Food Insecurity at the University of Maryland Yu-Wei Wang, Allison Tjaden, Brian Meko, Tiana Cruz, Israel Abebe University of Maryland, College Park	2:00PM–3:00PM Juan Ramon Jimenez	Out at Work: Uplifting LGBTQ+ Professionals Through Supervision Chase Oatis, Michael A. Goodman University of Maryland, College Park
11:20AM–12:20PM Benjamin Banneker B	Justice or “Just Us”? Social Justice in Unexpected Places Alice Mitchell, Jeremy Lightner University of Maryland, College Park	2:00PM–3:00PM Charles Carroll B	How To: Highly Effective Programming Kathleen Perry University of Maryland, College Park
11:20AM–12:20PM Pyon Su; GradTalks	“The Whole is Greater than the Sum of its Parts”: Perceptions of How Multiraciality is Taught at the Master’s Level Kamrie Risku University of Maryland, College Park	2:00PM–3:00PM Benjamin Banneker B	Identify and Engage: Having Tough Conversations with Students in Distress Leslie Krafft University of Maryland, College Park
	Outing Myself for a Survey: Ethical and Regulatory Issues in Conducting Research with Underage LGBTQ+ Students Nate Burke University of Maryland, College Park	2:00PM–3:00PM Benjamin Banneker A	Bring Your Whole Self to Work Monette Bailey University of Maryland, College Park
	Out of the Night that Covers Me: Black Greek Life as Spaces for Activism Kiyah McDermid University of Maryland, College Park	2:00PM–3:00PM Pyon Su	Sustainability in Student Affairs Panel Jaime Poynter, Allison Tjaden, Lisa Alexander University of Maryland, College Park
Session III		Session IV	
11:20AM–12:20PM Benjamin Banneker A	Incorporating Student Development Theory into Your Role as a Student Affairs Practitioner Earl Cabellon, Amanda Preperato, Hope Llanso University of Maryland, College Park	3:05PM–4:05PM Margaret Brent B	Need, Insecurity, and Student Survival: Creating a Campus that Decreases the Impact of Limited Personal Resources Brian Watkins, Alex Elliott University of Maryland, College Park
11:20AM–12:20PM Charles Carroll B	You Need a Guide: Institutionalizing Training and Support for High Turnover Positions Xanh Tran, Ashley Mena University of Maryland, College Park	3:05PM–4:05PM Prince George's	How to Design and Implement a Culturally Responsive Campus Climate Assessment Chad Kee Morgan State University, Jamie Washington Washington Consulting Group
11:20AM–12:20PM Prince George's	Residential Facilities Pros: Home Maintenance Tips for Your Fixer Upper! Tim Wheeler, John Page, Will Wheatley, Stanley Proctor, Carlos Schorchit, Oscar Melgar University of Maryland, College Park	3:05PM–4:05PM Benjamin Banneker B	From Beginning to End - Explore Project Management Tools and the Benefits They Can Bring Your Program William Post University of Maryland, College Park
11:20AM–12:20PM Margaret Brent B	Getting On Board: The Experience of Bringing on New Staff Steve Kreider, Mariah Raskin The Catholic University of America	3:05PM–4:05PM Margaret Brent A	“Here it’s Safe:” The Untold Stories of the Chapel Journals Sophie Tullier, Monique Oliver, Cherish Dargan, Ashley Edwards, Nhu Le University of Maryland, College Park
11:20AM–12:20PM Charles Carrol A	Jewish Student Life - Implications for Practice Madeline Reich University of Maryland, College Park	3:05PM–4:05PM Charles Carroll A CEU	Move Your Way to Wellness Tami Lee University of Maryland, College Park
2:00PM–3:00PM Charles Carroll A	Centering Multiracial Voices: A Panel Discussion on Multiraciality at the University of Maryland Kamrie Risku, Caitlin Moore, Hailla Vinson, Angel Graham, Priya Hay-Chatterjee University of Maryland, College Park	3:05PM–4:05PM Benjamin Banneker A	Redefining A Culture: Building A Foundation of Trust in Your Workplace Aspen Shackleford, Jordan Adams University of Maryland, College Park
2:00PM–3:00PM Margaret Brent B	Drafting a Quality Team Luke Verdi, Shawn Dennis, Jorge Herrera University of Maryland, College Park	3:05PM–4:05PM Charles Carroll B	Roundtable: Faith & Student Affairs Greta Haussmann, Anwtwann Harper The Catholic University of America
2:00PM–3:00PM Margaret Brent A	Finding Your Purpose in 2020 - Restorative Circle Opportunity Laura Tan, Ryan Manning University of Maryland, College Park	3:05PM–4:05PM Pyon Su	¿Se habla español? Los beneficios y las desventajas de hablar español o Spanglish en un espacio profesional Cazandra Rebollar, Laura Bohorquez Garcia University of Maryland, College Park
		3:05PM–4:05PM Juan Ramon Jimenez	This Is America: Are You Really Listening? Jorge Almonte-Florimon University of Maryland, College Park